

martin-thornton.com
01484 508000



**Firth Street,
Huddersfield, Yorkshire**

£800 Per month

*****AVAILABLE NOW*****

Superb 2 bedroom 2nd floor apartment in award winning development next door to Huddersfield University. Ent hall with storage, open plan living kitchen with integrated appliances. Master bed with en suite shower, 2nd bedroom and bathroom. Allocated parking, concierge service, Lift and on site gym.



Ground Floor

Approx. 63.3 sq. metres (681.5 sq. feet)

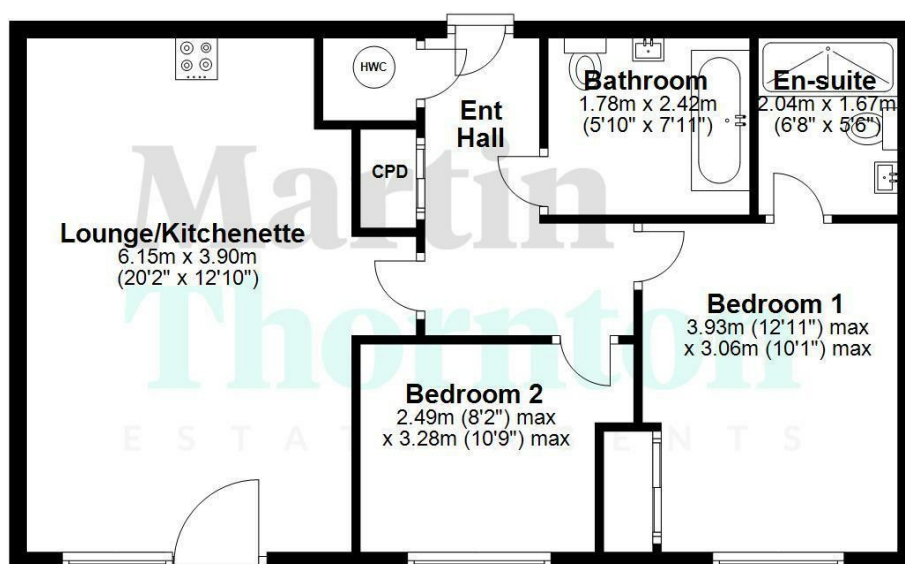

Total area: approx. 63.3 sq. metres (681.5 sq. feet)

This floor plan is intended to give a general indication of the proposed floor layout only. Dimensions should not be used for carpets, flooring, appliance spaces or items of furniture fixed or free standing.
Plan produced using PlanUp.

**Firth Street,
Huddersfield, Yorkshire**

Details



Firth Street, Huddersfield, Yorkshire

Directions

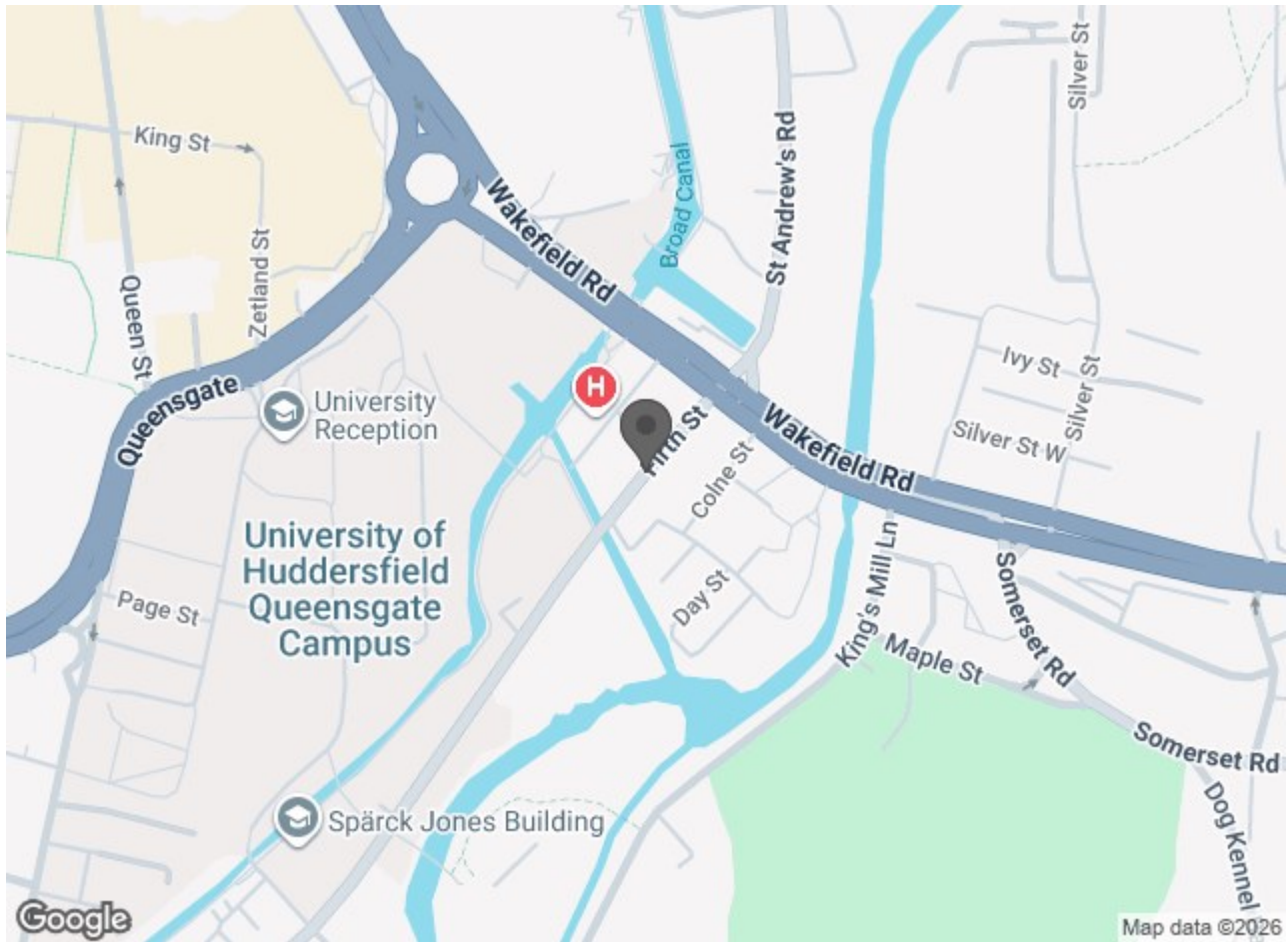

Firth Street, Huddersfield, Yorkshire

Lettings Disclaimer - As part of our application process, fees are not charged for a reference, the tenancy administration and the inventory check, however a holding deposit maybe required. Then if successful this will be deducted from the Rent and Deposit that will be payable before the tenancy is due to start. Please contact us for full details before you make any decision about this property or before you decide to view this property. While every reasonable effort is made to ensure the accuracy of descriptions and content, we should make you aware of the following guidance or limitations. 1 Prospective tenants will be asked to produce identification documentation during the referencing process and we would ask for your co-operation in order that there will be no delay in agreeing a tenancy. 2 These particulars do not constitute part or all of an offer or contract. 3 Photographs and plans are for guidance only and are not necessarily comprehensive. 4 The approximate room sizes are only intended as general guidance. You must verify the dimensions to satisfy yourself of their accuracy. 5 You should make your own enquiries regarding the property, particularly in respect of furnishings to be included/excluded and what parking facilities are available.